

2019

MUSKEGON COUNTY WASTEWATER MANAGEMENT SYSTEM ARCHERY DEER, ARCHERY TURKEY, ARCHERY COYOTE HUNTING RULES

A B S O L U T E L Y N O F I R E A R M S A L L O W E D

PROCEDURE

Permit Issuance

Applicants interested in hunting at the Wastewater facility should appear at the Administration Building located at 698 N. Maple Island Road between the hours of 8 a.m. and 5 p.m., Monday through Friday. A valid annual permit is required prior to hunting on this site.

Permits will be issued on a first-come, first-served basis and will be limited to 300 for both the early and late bow season and for bow hunting during the firearm season.

<u>Permit Fees:</u>	Early and Late Bow Season	\$35.00
	Bow hunting during Firearm Season	\$35.00
	Military Veterans w/ valid DD-214 or ID Card	N/C

Early Season is from October 1 thru November 14.

Late Season is from December 1 thru January 1.

Archery during firearm season is from November 15-November 30.

Turkey Season is from September 15 thru November 14.

Coyote Season is from October 15 thru April 15, 2020

NO REFUNDS!

Hours for hunting shall be one-half hour before sunrise until one-half hour after sunset, daily. Hours of admittance shall include a reasonable amount of time before and after hunting hours to accommodate setup and takedown activities. Any judgment necessary shall be determined by law enforcement officials or county staff on a case-by-case basis.

Access will be from the gates on Apple Ave., Maple Island Rd., Hall Rd., and Sullivan Rd. Hunters are restricted to travel on existing main and pivot roads only (see attached map). They may not drive across or around fields.

Parking is the hunter's liability and must be off, but within close proximity of, all roads, not disrupt Wastewater System operations, and not be in the way of irrigation rig towers and drop pipes (to avoid vehicle damage).

Scouting is allowed in advance of the season for hunters that have been issued permits, but 'shining' is prohibited.

GENERAL RULES

1. The **hunting area** is depicted on the attached map. Hunting is **not** permitted in the restricted areas. Hunting shall be allowed in the designated areas by PERMIT only. No hunting is permitted on Wastewater property outside the fenced areas (such as north of the fence next to

Mosquito Creek). **The area immediately north of the southernmost fence line south of Apple Ave., and the clay pit area are restricted areas, without exception.** If there is any question, County staff or the Sheriff's Deputy should be consulted.

2. Archery hunting during the firearm season is by permit, separate from the early and late season permit. All state rules in effect during the firearm season must be followed (e.g., must wear hunter orange).
3. All hunters shall possess and exhibit a valid and applicable Michigan hunting license, a valid Wastewater permit, and display the Wastewater tag in the window of their vehicle. Each hunter must possess their own Wastewater hunting permit.
4. Hunters' equipment and tag shall be subject to inspection at all times by County staff.
5. No permanent blinds or permanent tree stands will be allowed; however, temporary portable blinds or portable stands will be permitted. **All temporary blinds and stands must be removed every day.**
6. No target practice will be permitted within the hunting areas.
7. No arrows shall be discharged within 50 feet of the fenced boundaries of the site.
8. No arrows shall be discharged within 500 feet of any building or mechanical structure, including, but not limited to, exposed pipes, spray irrigation rigs, pumps, etc.
9. No hunting is permitted in areas where harvest or construction activities are in progress.
10. All hunting shall be subject to all applicable laws of the State of Michigan, which shall be strictly enforced.
11. Any person who damages any County property shall be liable for such damage.
12. Violation of these rules by any hunter shall result in the immediate revocation of the permit, and the hunter shall be subject to expulsion from the area as a trespasser as well as prosecution for violating the same or other applicable laws. Revocation of one's permit may result in ineligibility for hunting access in subsequent years.
13. No littering shall be permitted. No bottles or cans will be allowed in the area. No alcoholic beverages are permitted on site at any time.
14. No driving of deer is permitted by any means or method. This includes individuals or groups on foot or in vehicles.
15. No firearms on person or in the vehicle shall be permitted at any time.
16. No Off-Road Vehicles are permitted on site.

WILD TURKEY HUNTING

Archery hunting of wild turkey will be permitted during the fall season under these rules at no extra fee. The taking of wild turkey shall be subject to all state and county regulations. All archery deer hunting regulations stated in these rules shall also apply. **The hunter must possess appropriate public land permit valid for this zone.**

ARCHERY COYOTE HUNTING

Archery hunting of coyote will be permitted during the winter season under these rules at no extra fee. The taking of coyote shall be subject to all state and county regulations. In addition **NO DOGS WILL BE PERMITTED FOR COYOTE HUNTING.** Hunting hours shall be one half hour before sunrise to one half hour after sunset. All archery deer hunting regulations stated in these rules shall also apply. **The hunter must possess appropriate licenses.**

CONDITIONS

Each hunter shall be liable for any injury or death to persons or damage to property. The County shall not be liable for the recklessness or carelessness of other hunters. Every person shall use reasonable care for his or her own safety.

The County does not represent or guarantee that any game taken from the Wastewater Site is fit for human consumption. Each hunter should carefully examine the game for evidence of illness or disease in the same manner as game from other areas would be examined if used for human consumption.

The permit is granted for archery deer hunting, archery turkey hunting, and archery coyote hunting (as set forth above) purposes only. No other game hunting is permitted by these rules.

The County reserves the right to alter or amend these rules and regulations at any time if circumstances so require. No refunds of permit or other fees will be given.

The County will have a Sheriff's Deputy assigned to monitor the bow hunt again this year. Please report any observance of violations to the Deputy or County staff.

Muskegon County Wastewater Hunting Map 2019

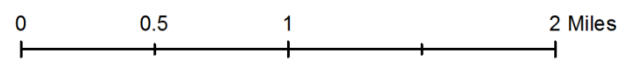
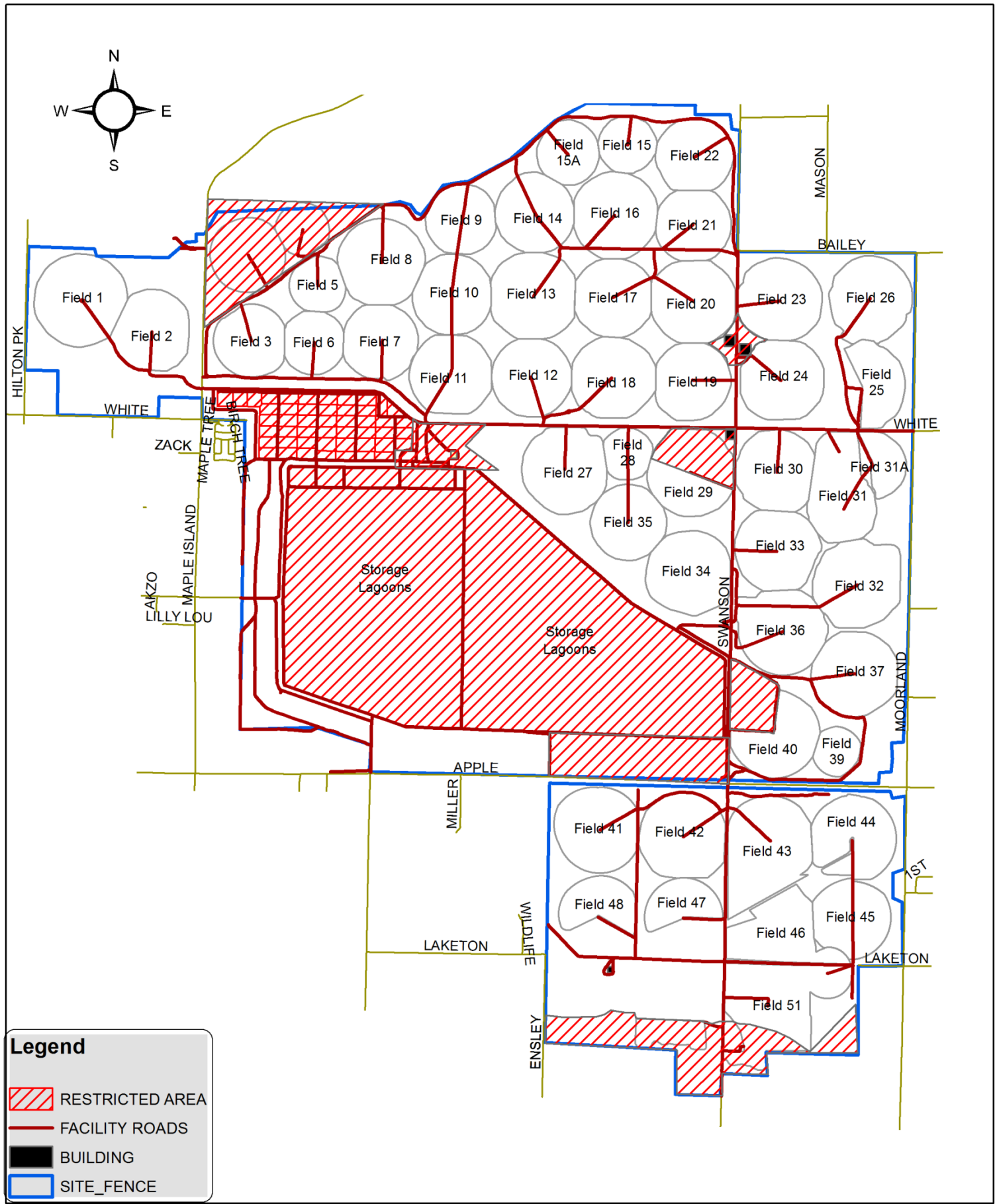
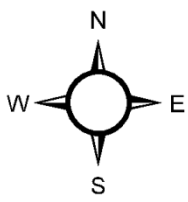

APPLICATION FOR SPECIAL USE HUNTING PERMIT
AT MUSKEGON COUNTY WASTEWATER MANAGEMENT SYSTEM

Name of Applicant (PRINT)

Address

City, State, Zip

(____)_____
Telephone Number

Check Seasons Desired:

Early & Late Season (\$35)

November 15-30 (\$35)

Veteran with valid DD-214(\$0)

Active Duty Military w/ID(\$0)

Muskegon County Veteran ID card
also valid

hereby makes application for a **SPECIAL USE HUNTING PERMIT** on Muskegon County Wastewater Management System property. By signature, affixed hereto, applicant expressly agrees to comply with all Special Use and Hunting Rules as applicable to the issuance of such permit; applicant further, as a condition to issuance of such permit, acknowledges receipt of copies of said Rules, and applicant furthermore represents that he/she shall comply with all State law requirements regarding the issuance of State licenses, etc., as may be required for undertaking such hunting.

WAIVER AND INDEMNITY

Provided further, applicant acknowledges and agrees, as a further condition to issuance of Permit, that applicant agrees to indemnify and hold harmless the County of Muskegon, its agents, employees, and instrumentalities against any and all claims, demands, suits, loss, including all costs connected therewith, by reason of personal injury, including bodily injury or death and/or property damage including use thereof, which arises out of or is in any way connected with or associated with activities undertaken by applicant under Permit issued on the basis of this application.

Signature of Applicant or
Signature for Minor Child

Date

Were you successful last year?(Circle) Buck Doe None